

ROLLERS

Rollers:

Standard: Hard chromium plated

Option: Hardened Plasmacoted, Polyamide

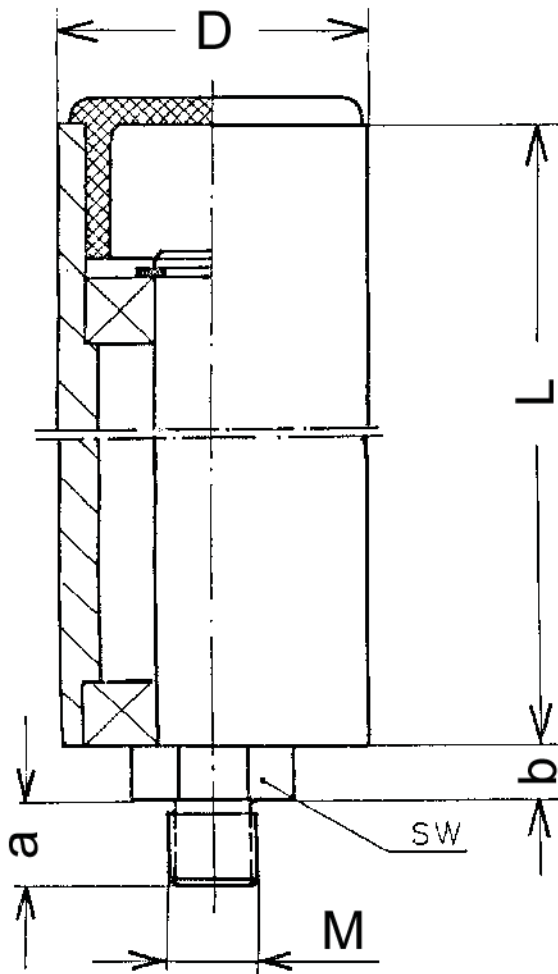

ØD	15	20	20	20	20	30	30	30	30	40	40	40	40	40	40	60	60	60	60
L	80	40	60	80	100	40	60	90	110	60	90	110	150	200	250	110	130	150	160
SW	10	14	14	14	14	17	17	17	17	17	17	17	17	17	17	22	22	22	22
M	6	8	8	8	8/10	12	12	12	12	12	12	12	12	12	12	12	12	12	12
a	12	10	10	10	10	12	12	12	12	12	12	12	12	12	12	12	12	12	12
b	7	7	7	7	7	7	7	7	7	7	7	7	7	7	7	9	9	9	9

Other dimensions on request

Drawing No. 3-400070-00

20-09-2011

Address: Sprängarvägen 16
SE- 132 38 Saltsjö-Boo
Sweden

Phone: +46-8-88 46 33
Fax: +46-8-97 76 58

Email: info.subec.se
Web: www.subec.se

ROLLERS

Rollers:

Standard: Hard chromium plated

Option: Hardened Plasmacoted, Polyamide

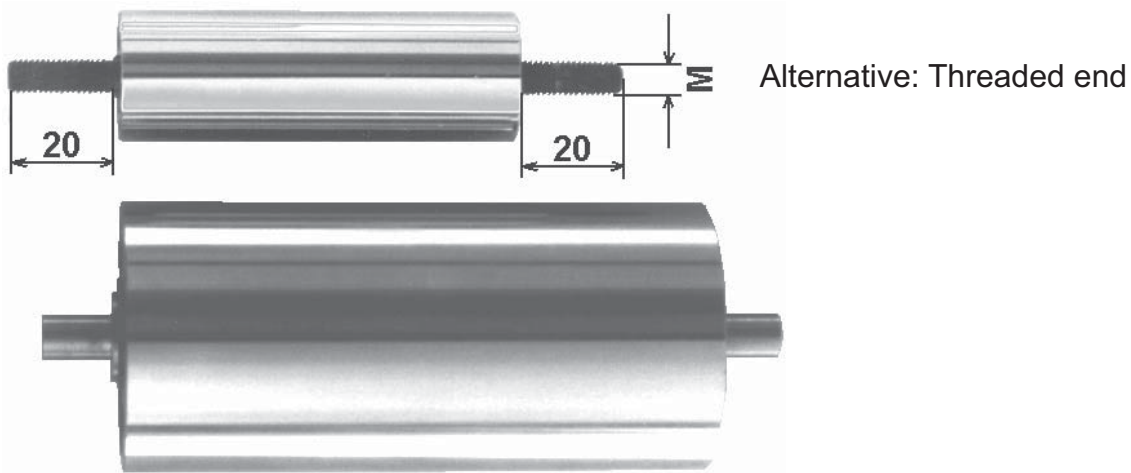
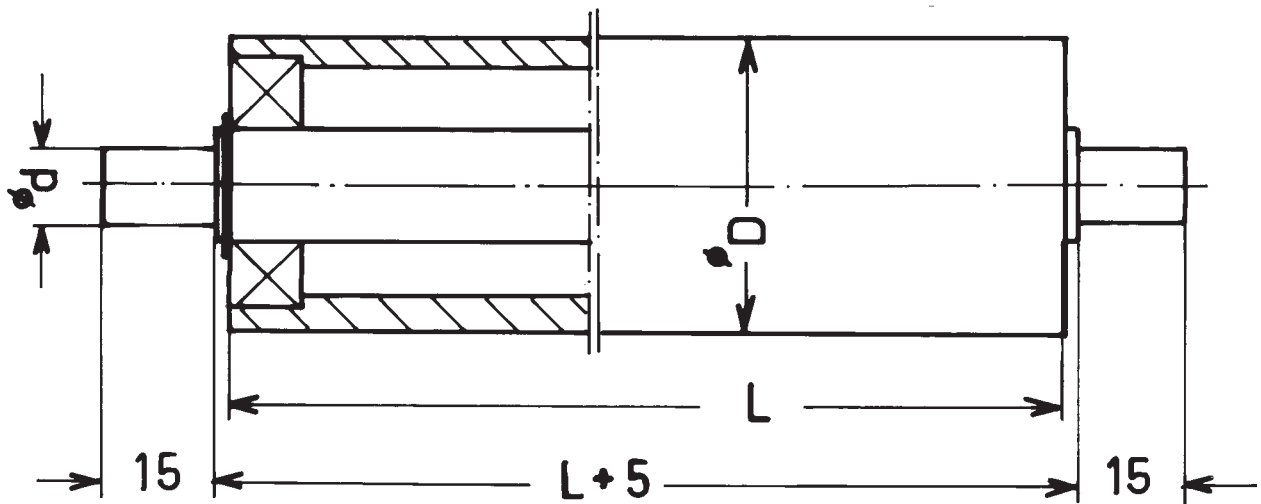

ØD	20	20	20	20	30	30	30	30	40	40	40	40	40	40	60	60	60	60
L	40	60	80	100	40	60	90	110	60	90	110	150	200	250	110	130	150	160
Ød	8	8	8	8	10	10	10	10	10	10	10	10	10	10	10	10	10	10
M	8	8	8	8	8	8	8	8	12	12	12	12	12	12	12	12	12	12

Other dimensions on request

Drawing No. 3-400169-00

20-09-2011

Address:	Sprängarvägen 16 SE- 132 38 Saltsjö-Boo Sweden	Phone:	+46-8-88 46 33	Email:	info.subec.se
		Fax:	+46-8-97 76 58	Web:	www.subec.se

ROLLERS

Polyurethane Coating: 90 Shore A

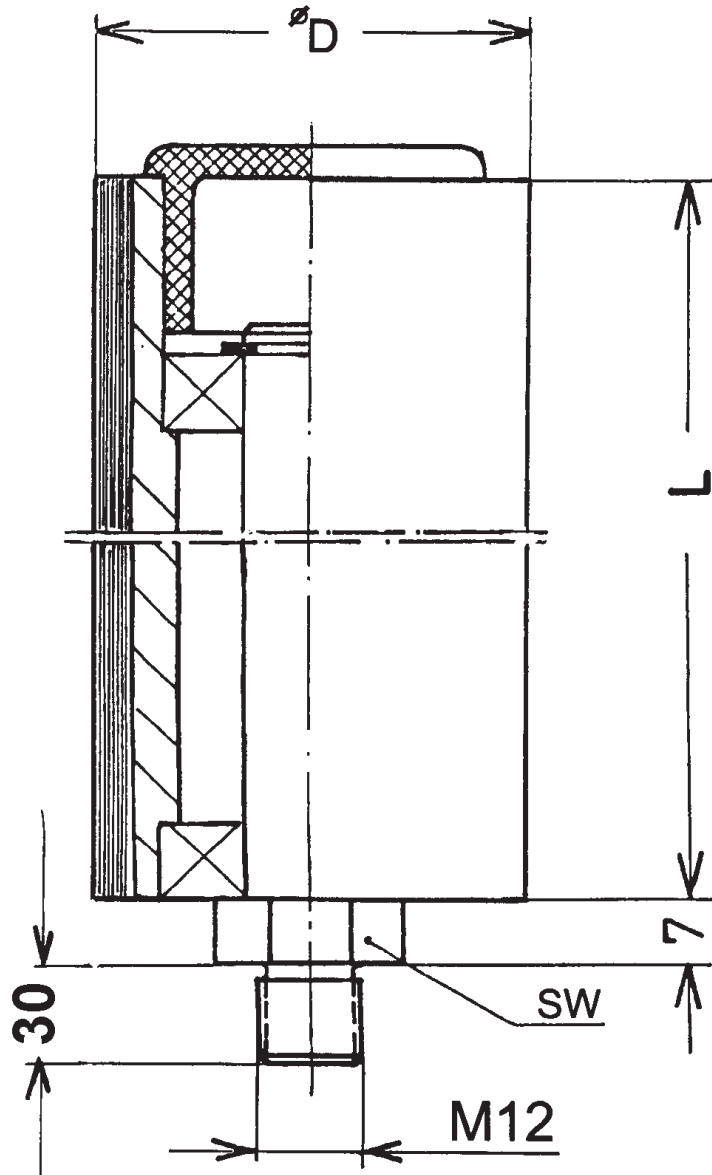

Article: 32

D= 15mm
L= 150mm
SW= 17mm

Other dimensions on request

Drawing No. 3-400235-00

20-09-2011

Address: Sprängarvägen 16 SE- 132 38 Saltsjö-Boo Sweden	Phone: +46-8-88 46 33 Fax: +46-8-97 76 58	Email: info.subec.se Web: www.subec.se
--	--	---

ROLLERS

Rollers:

Standard: Hard chromium plated

Option: Hardened Plasmacoted, Polyamide

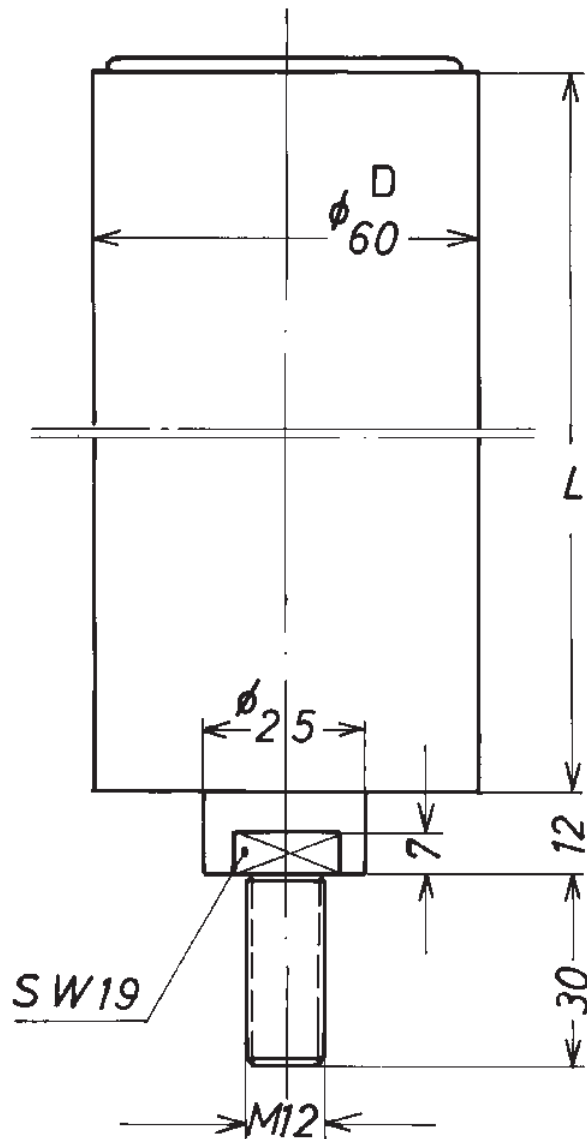

ØD	60	60	60	60
L	160	200	220	300

Drawing No. 3-400287-00

20-09-2011

Address:	Sprängarvägen 16 SE- 132 38 Saltsjö-Boo Sweden	Phone:	+46-8-88 46 33	Email:	info.subec.se
		Fax:	+46-8-97 76 58	Web:	www.subec.se

ROLLERS

Rollers:

Standard: Hard chromium plated

Option: Hardened Plasmacoted, Polyamide

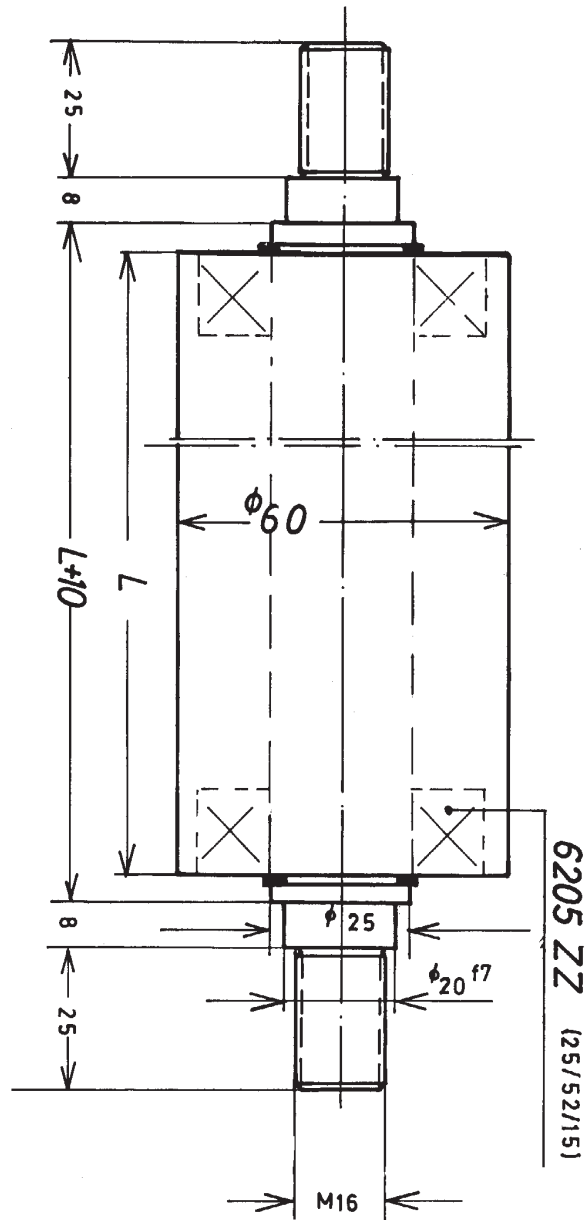

ØD	60	60	60	60
L	120	140	170	485

Other dimensions on request

Drawing No. 3-400288-00

20-09-2011

Address:	Sprängarvägen 16 SE- 132 38 Saltsjö-Boo Sweden	Phone:	+46-8-88 46 33	Email:	info.subec.se
		Fax:	+46-8-97 76 58	Web:	www.subec.se

ROLLERS

Rollers:

Standard: Hard chromium plated

Option: Hardened Plasmacoted, Polyamide

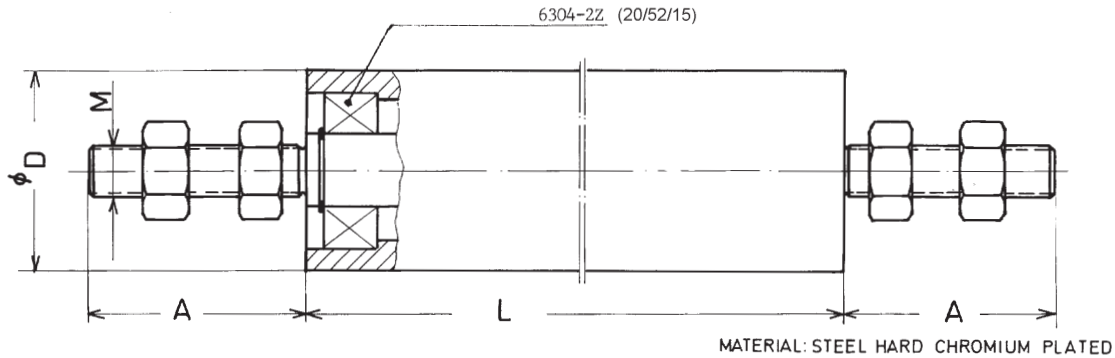
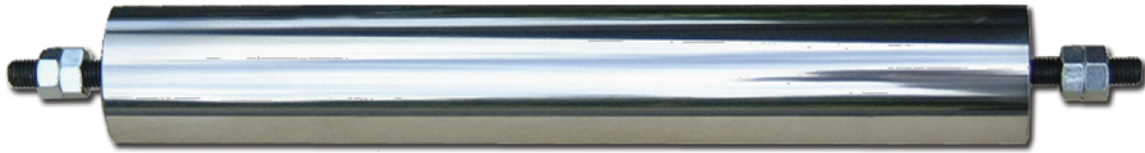

ØD	L	A	M	Prod Id	
				Cr.	Hardened
50	250	47,5	12	526	
50	280	47,5	8		
60	180	47,5	12	34	
60	195	47,5	12		4898
60	220	47,5	12	36	
60	250	47,5	12	37	2111
60	320	47,5	12	1869	2142
60	380	47,5	12		1166
60	400	30	12	1154	
60	450	55	12	2035	
60	540	55	12	2061	5160
60	660	55	12		
60	680	47,5	12		
60	780	47,5	12		
60	900	47,5	12	38	
60	1000	47,5	12	1762	
60	1100	47,5	12	39	
70	200	47,5	16	40	
75	762	76			2062
80	250	47,5	12	1174	
80	1000	47,5	20	41	2477

Other dimensions on request

Drawing No. 3-400233-03

20-09-2011

Address:	Sprängarvägen 16 SE- 132 38 Saltsjö-Boo Sweden	Phone:	+46-8-88 46 33	Email:	info.subec.se
		Fax:	+46-8-97 76 58	Web:	www.subec.se

Rollers

Rollers : Standard:
 Hard chromium plated,
 Option: Hardened,
 Plasmacoted, Polyamide

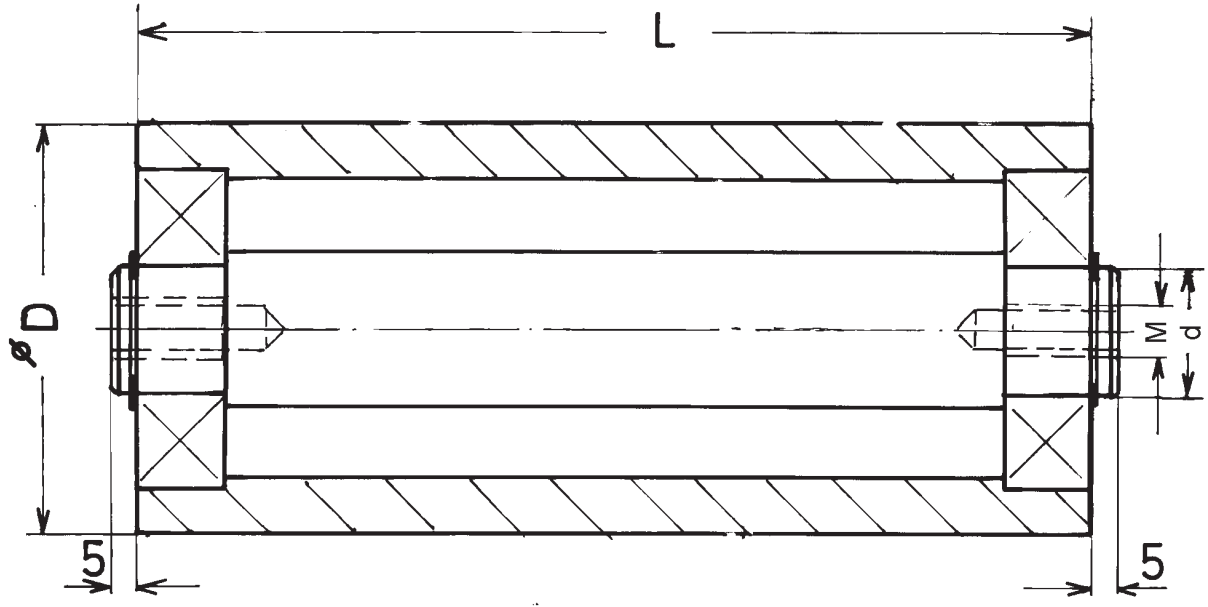

$\varnothing D$	d	L	M	
80	25	300	M14	
80	25	385	M12	
80	25	469	M12	
160			M18	

Other dimentions on request

000125

DRAWING NO. 3-400289-01

Rollers

Rollers : Standard:
 Hard chromium plated,
 Option: Hardened,
 Plasmacoted, Polyamide

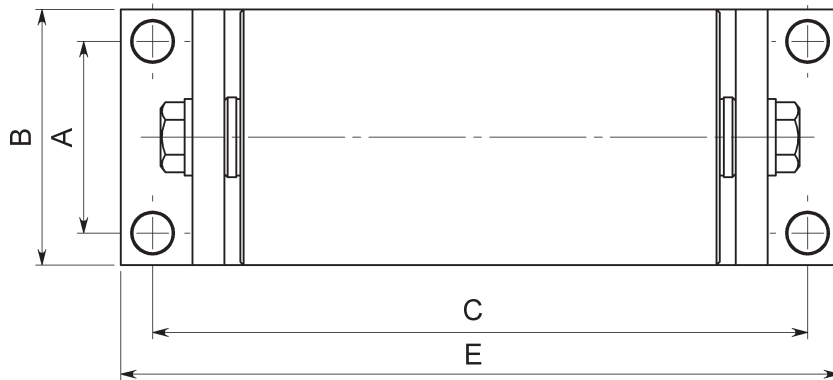
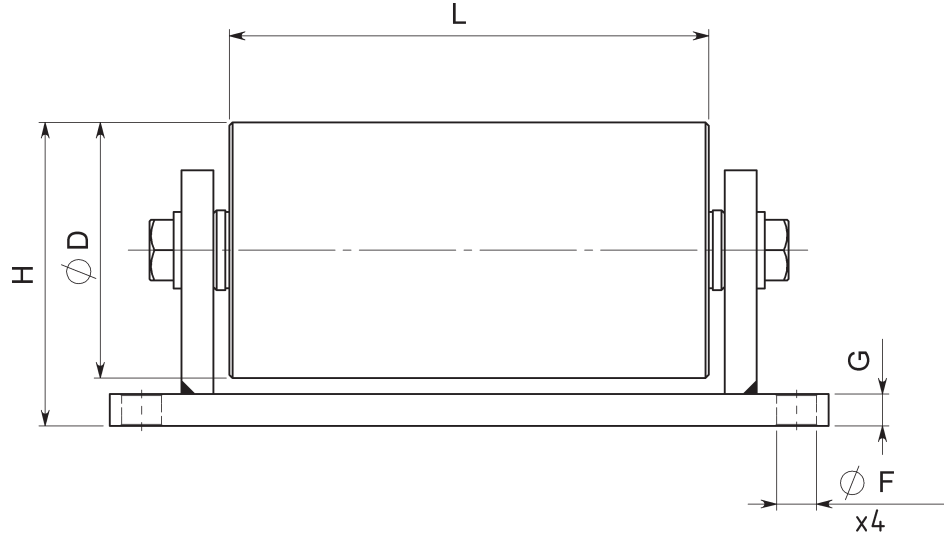

Roller Ø	A	B	C	E	F	G	H	L
80	60	80	205	225	4xØ12,5	10	95	150

Other dimentions on request

DRAWING NO. 3-400529-00

030508

Address: Sprängarvägen 16
 SE- 132 38 Saltsjö-Boo
 Sweden

Phone: +46-8-88 46 33
 Fax: +46-8-97 76 58

E-mail: info@subec.se
 Web: www.subec.se